



## ROLLER SHADE

# Hardwire Motor

A high voltage controlled and switched motor that can be wired in parallel. This motor must be wired directly to an in-line rocker switch (Leviton 5657-2W). Motors can be “daisy chained” together but are not to exceed the current rating of the circuit. Each motor comes with 12 feet of cord and a built-in disconnect.

- Motor power: 6.0Nm
- Motor size: compatible with 2” tube, or 2.5” tube with adapter
- Minimum shade width: 28”
- Maximum shade size:
  - On 2” tube— 96” wide x 144” long
  - On 2.5” tube — 120” wide x 180” long

### Components

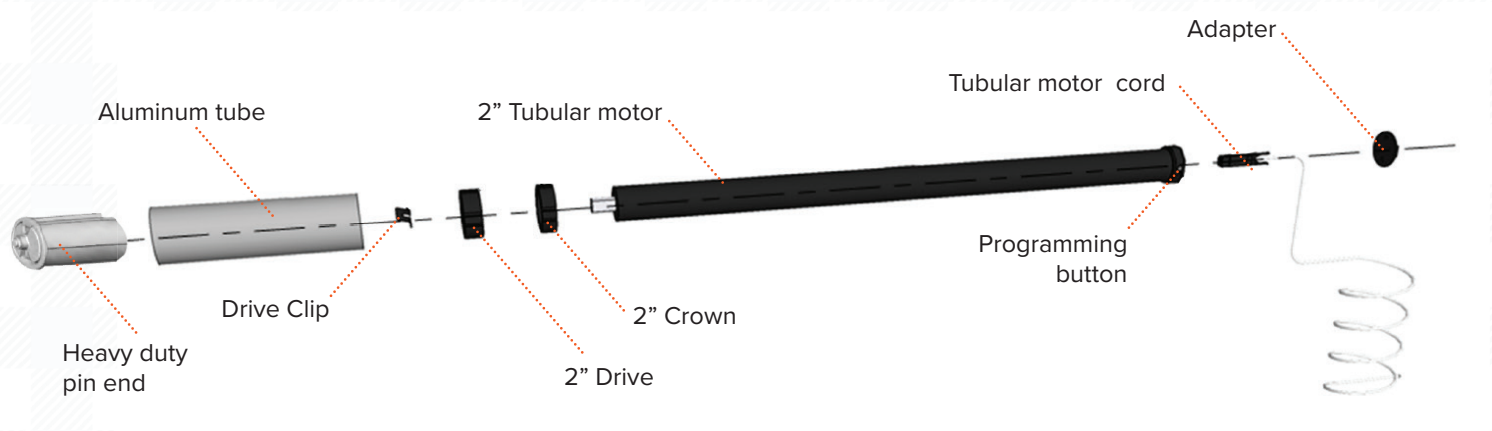

### Close-up

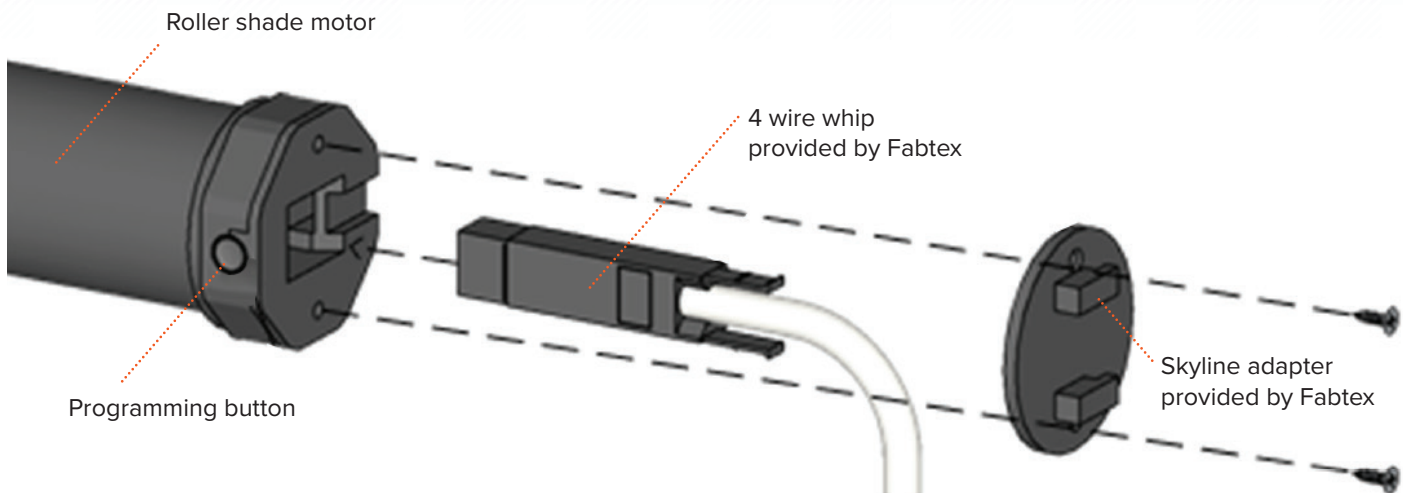

**Requires** - Standard 120VAC power supply provided & installed by EC/GC (all connections), must be hardwired.

**Controls Available** - Leviton #5657 Rocker Switch (Recessed) to be provided & installed by EC/GC (or equal).

**Tube Size** - Compatible with 2” Diameter Tube (Standard Crown & Drive). also compatible with 2-1/2” Diameter Tube (Requires larger Crown & Drive).

## Wiring

